

N side of SW Harbord Drive E of SW Naito Parkway

Task	Side	Street	Dir	Cross Street	Measured From	Block Length
A	N	SW Harbord Drive	E	SW Naito Parkway	NE Curb	822
B	N	SW Clay Street	W	SW Naito Parkway	NW Curb	

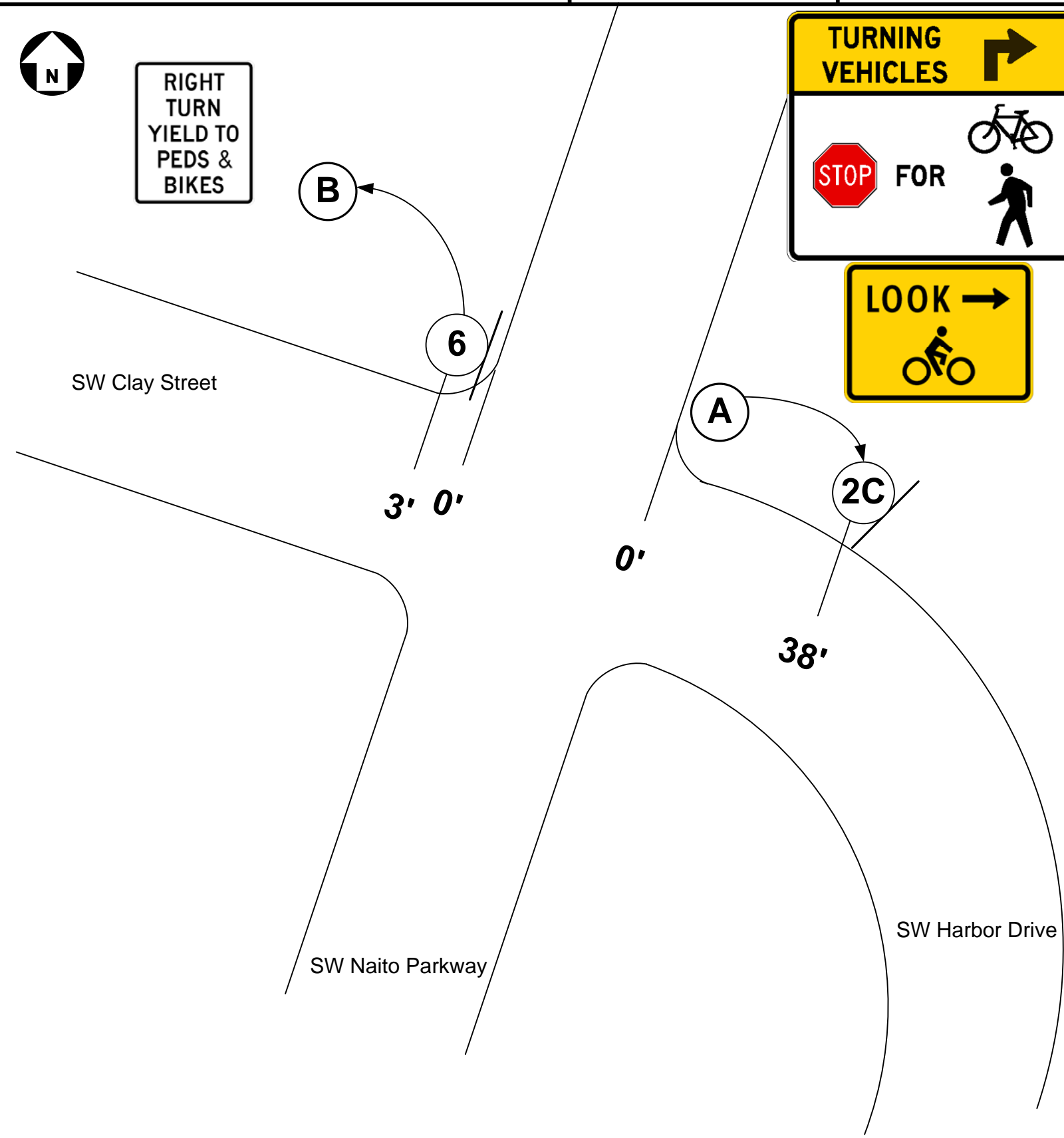

Task	Placement (Ft from 0')	Activity	Code	Description	Other Instructions	*Staked for Locate?	Sign Height	Date Complete
A1	38	Install	2C	Steel Pipe Post		Y		
A2	38	Install	R4614	Turning Veh Stop for Ped Bike				
A3	38	Install	W3267R	Look Right Bikes				
B1	3	Exist	6	Street Light Pole				
B2	3	Remove	R4470R	Right Turn Yield to Peds and Bikes				

All locates require field markings with white stake and "COP LOCATE -->" painted (white) in street. Locates are required for embedded pipe installations (2, 2S, 2C, etc) – See sign mount list for details.

* Sign height is, by default, 7 feet and does not need to be shown. A non-standard sign height, if known in advance, should be noted by the work order originator. Otherwise, field staff will indicate actual sign height after installation.

Task	Placement From	To	Activity	Status	Pavement Markings	Material	Date Complete

Task	Activity #	WO#	Crew	Locate	Dig Date	Dig Time	Other Instructions	Date

Paving List Conflict Review (Reviewed Paving List and determined there were no conflicts with this work order).

Reviewed By: **Mark Haines**

Date list reviewed: **11/05/2013**

Originator Notes:

- Required input by WO Originator
- Input optional for clarity or other information
- Input by field crews

BOM Install Notes: _____