

FRONT PERSPECTIVE VIEW - ASHP 2013 MID-YEAR MEETING

SCALE: NTS

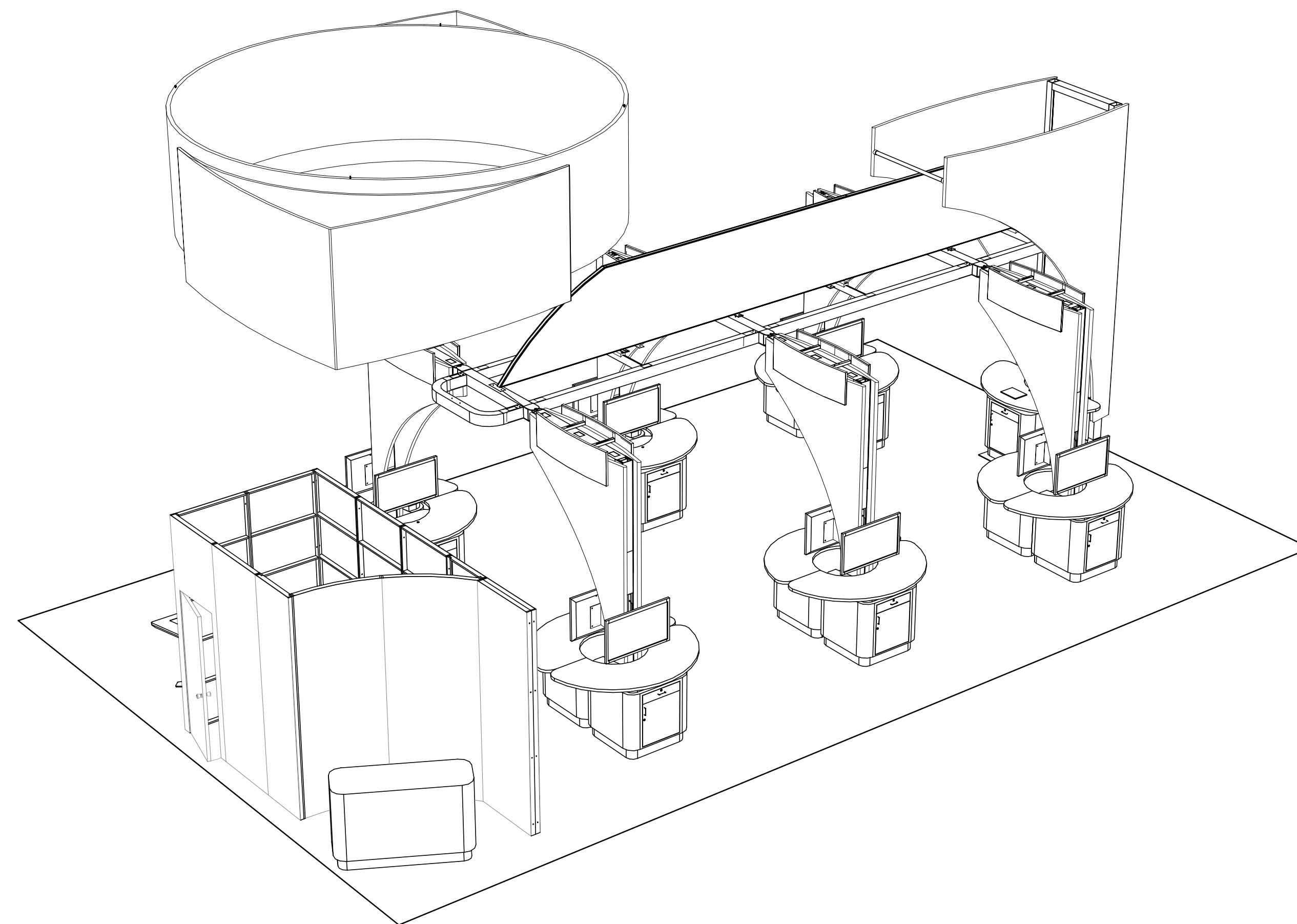

REAR PERSPECTIVE VIEW - ASHP 2013 MID-YEAR MEETING

SCALE: NTS

www.czarnowski.com | \DEN\F5\Office\CAD\2013\Hospira\ASHHP\Hospira - ASHP_2013_30x50 - Setups_v1.dwg - 11/14/2013

Czarnowski
We love what we do.

Exhibit Services | Strategic Services | Event Services
11175 East 55th Avenue, Suite 100 Phone: 303.371.3344
Denver, CO 80239 Fax: 303.371.3437

Copyright © 2013 Czarnowski
The contents of this document are the property of Czarnowski and may not be reproduced, distributed, transmitted, displayed, or published without the prior written permission of Czarnowski.

ACCT. EXEC.	DESIGNER	DETAILER		
		TH / PDL		
CREATION DATE	ISSUE DATE	RELEASE DATE		
11.12.13				
CLIENT NAME				
HOSPIRA				
SHOW NAME				
ASHP 2013 - MID-YEAR CLINICAL MEETING				
VENUE				
ORANGE COUNTY CONVENTION CENTER ORLANDO, FL				
SETUP DATE	SHOW START	SHOW END		
	12.7.13	12.11.13		
BOOTH NUMBER	BOOTH AREA	HEIGHT RESTRICTION		
923	30x50			
SHEET NAME				
PERSPECTIVE VIEWS				
PROJECT NUMBER	CLIENT	CITY	YEAR	SHEET

HOSPIRA ASHP 2013 10

BOOTH #931

BOOTH #1031

BOOTH #926

BOOTH #922

BOOTH #1127

BOOTH #1123

BOOTH #915

BOOTH #1013

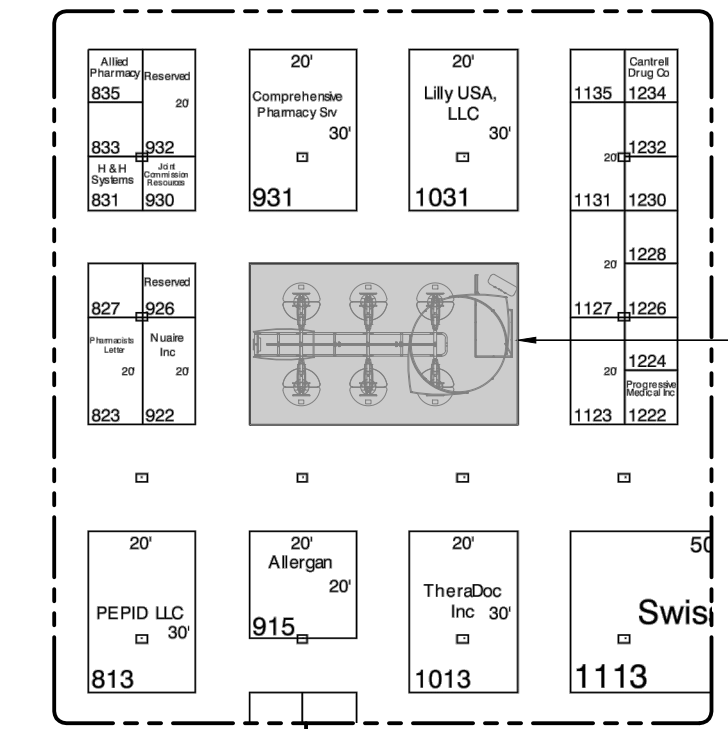
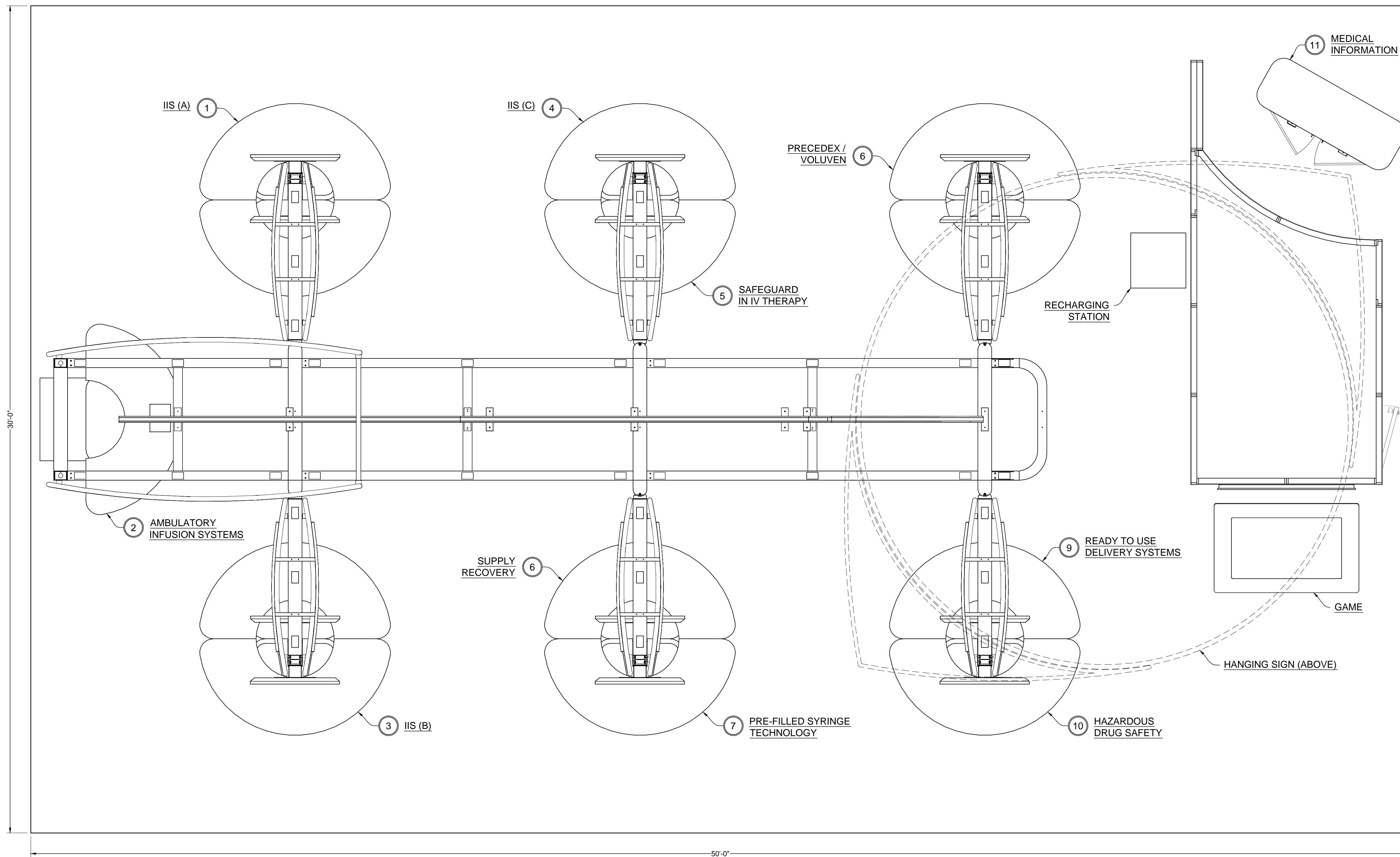

HOSPIRA
BOOTH #923

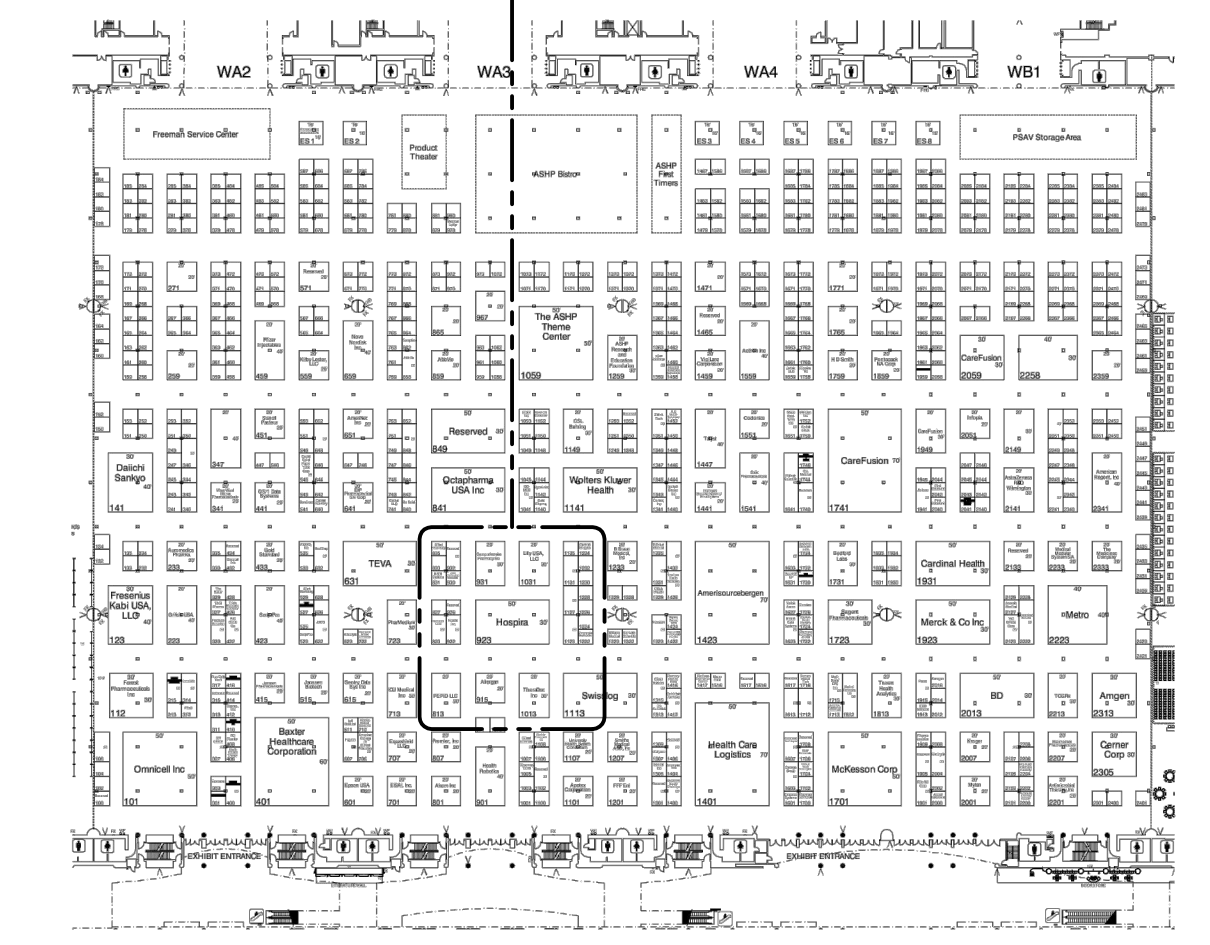

ASHP SHOW PLAN
SCALE: N/A

PLAN VIEW - FLOOR PLAN LAYOUT
SCALE: 1/2" = 1'-0"

Czarnowski
We love what we do.

Exhibit Services | Strategic Services | Event Services
11175 East 55th Avenue, Suite 100 Phone: 303.371.3344
Denver, CO 80239 Fax: 303.371.3437

Copyright © 2013 Czarnowski
The contents of this document are the property of Czarnowski and may not be reproduced, distributed, transmitted, displayed, or published without the prior written permission of Czarnowski.

ACCT. EXEC.	DESIGNER	DETAILER
		TH / PDL
CREATION DATE	ISSUE DATE	RELEASE DATE
11.12.13		
CLIENT NAME		
HOSPIRA		
SHOW NAME		
ASHP 2013 - MID-YEAR CLINICAL MEETING		
VENUE		
ORANGE COUNTY CONVENTION CENTER ORLANDO, FL		
SETUP DATE	SHOW START	SHOW END
	12.7.13	12.11.13
BOOTH NUMBER	BOOTH AREA	HEIGHT RESTRICTION
923	30x50	
SHEET NAME		
FLOOR PLAN LAYOUT		
PROJECT NUMBER CLIENT CITY YEAR		
HOSP		PRELIMINARY 13.2.0

www.czarnowski.com \DENVER\Office\CAD\2013\Hospira\ASHP\Hospira - ASHP_2013_30x50 - Setups_v1.dwg - 11/14/2013

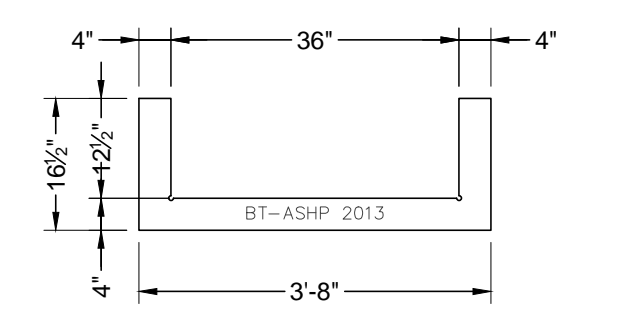
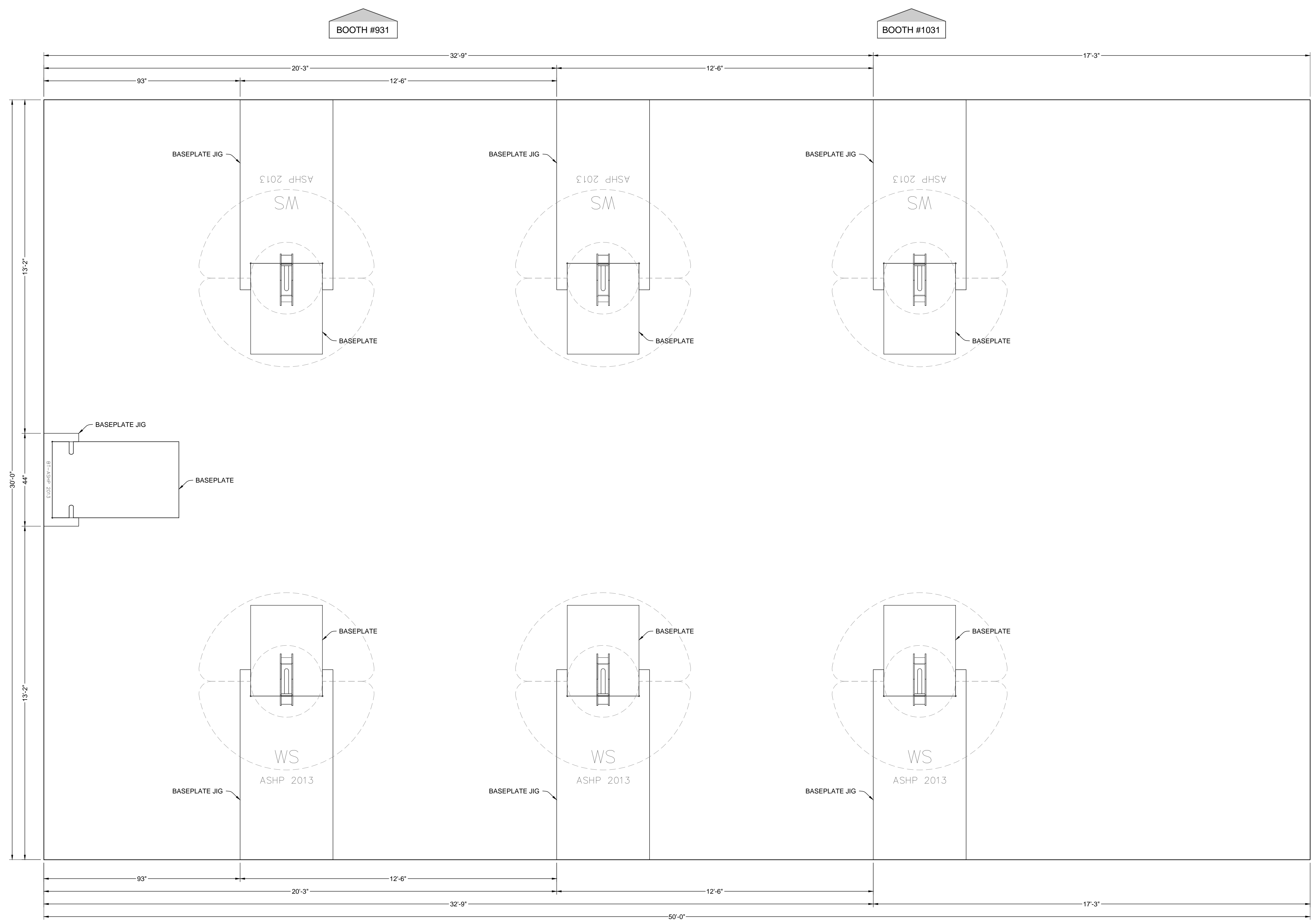

BASEPLATE JIG - BT
SCALE: 1/2" = 1'-0" (1 REQ'D)

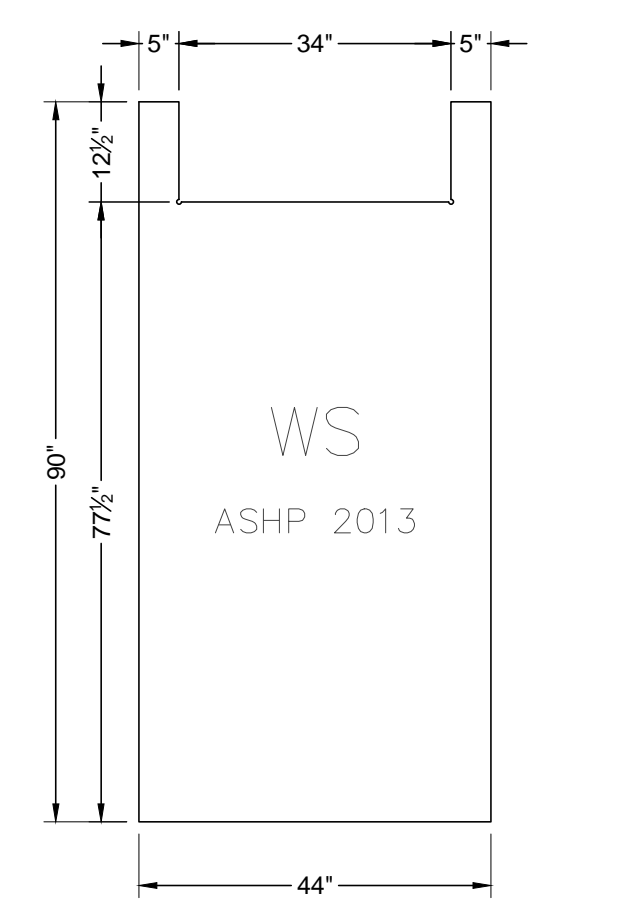

BASEPLATE JIG - WS
SCALE: 1/2" = 1'-0" (6 REQ'D)

PLAN VIEW - BASEPLATE LAYOUT
SCALE: 1/2" = 1'-0"

Czarnowski
We love what we do.

Exhibit Services | Strategic Services | Event Services
11175 East 55th Avenue, Suite 100 Phone: 303.371.3344
Denver, CO 80239 Fax: 303.371.3437

Copyright © 2013 Czarnowski
The contents of this document are the property of Czarnowski and may not be reproduced, distributed, transmitted, displayed, or published without the prior written permission of Czarnowski.

ACCT. EXEC.	DESIGNER	DETAILER
		TH / PDL
CREATION DATE	ISSUE DATE	RELEASE DATE
11.12.13		
CLIENT NAME		
HOSPIRA		
SHOW NAME		
ASHP 2013 - MID-YEAR CLINICAL MEETING		
VENUE		
ORANGE COUNTY CONVENTION CENTER		
ORLANDO, FL		
SETUP DATE	SHOW START	SHOW END
	12.7.13	12.11.13
BOOTH NUMBER	BOOTH AREA	HEIGHT RESTRICTION
923	30x50	
SHEET NAME		
BASEPLATE LAYOUT		
PROJECT NUMBER	CLIENT	CITY
PROJECT NUMBER		SHEET
HOSP 923		13.2.1

www.czarnowski.com | \\DEN-FS\Office\CAD\2013\Hospira\ASHP\Hospira - ASHP_2013_30x50 - Setups_v1.dwg - 11/14/2013

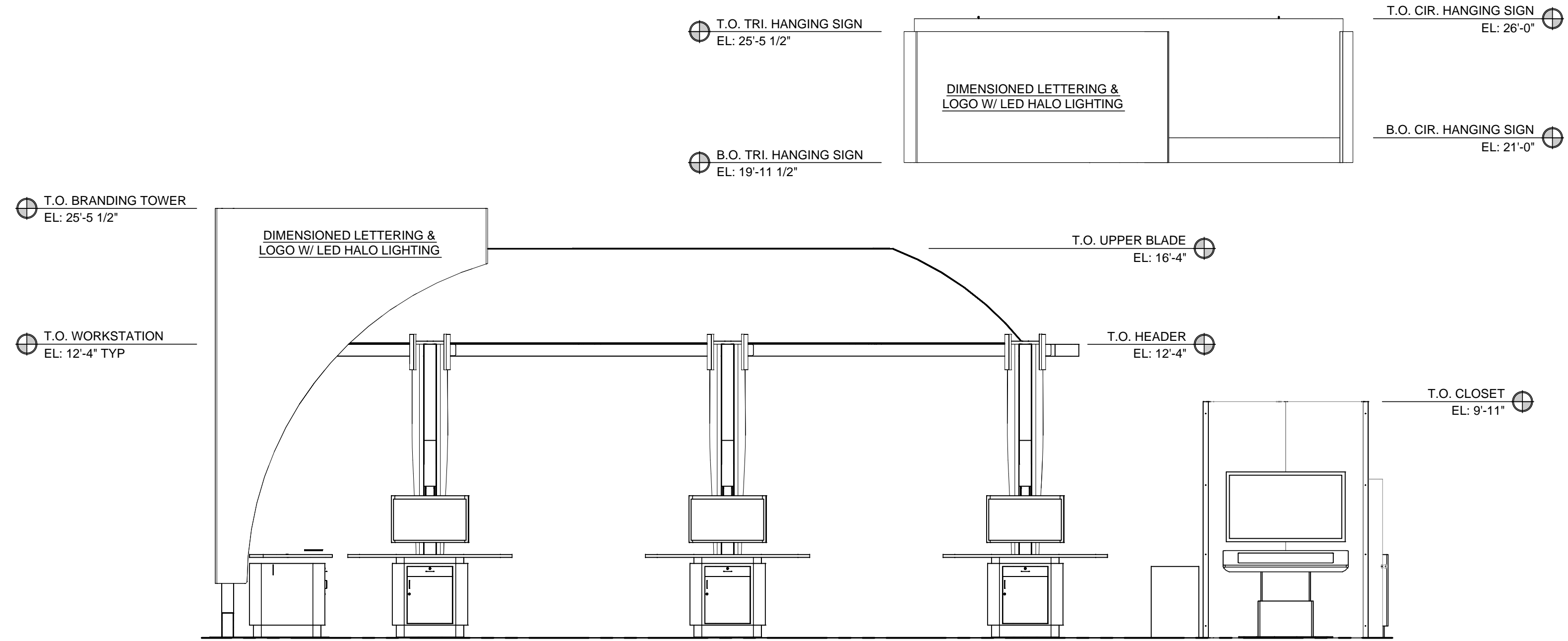

FRONT SIDE ELEVATION VIEW

SCALE: 1/4" = 1'-0"

1
3.0

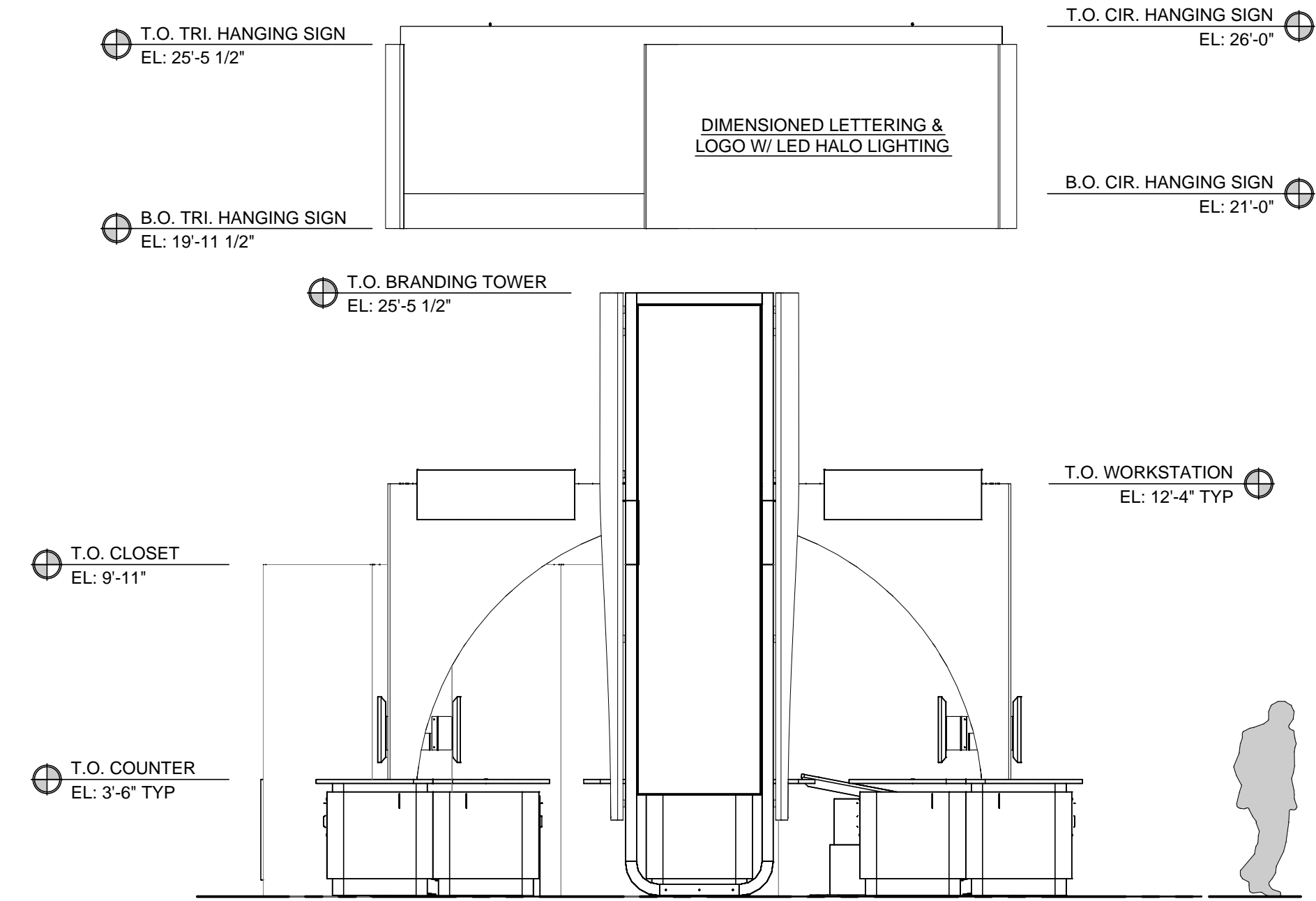

LEFT SIDE ELEVATION VIEW

SCALE: 1/4" = 1'-0"

2
3.0

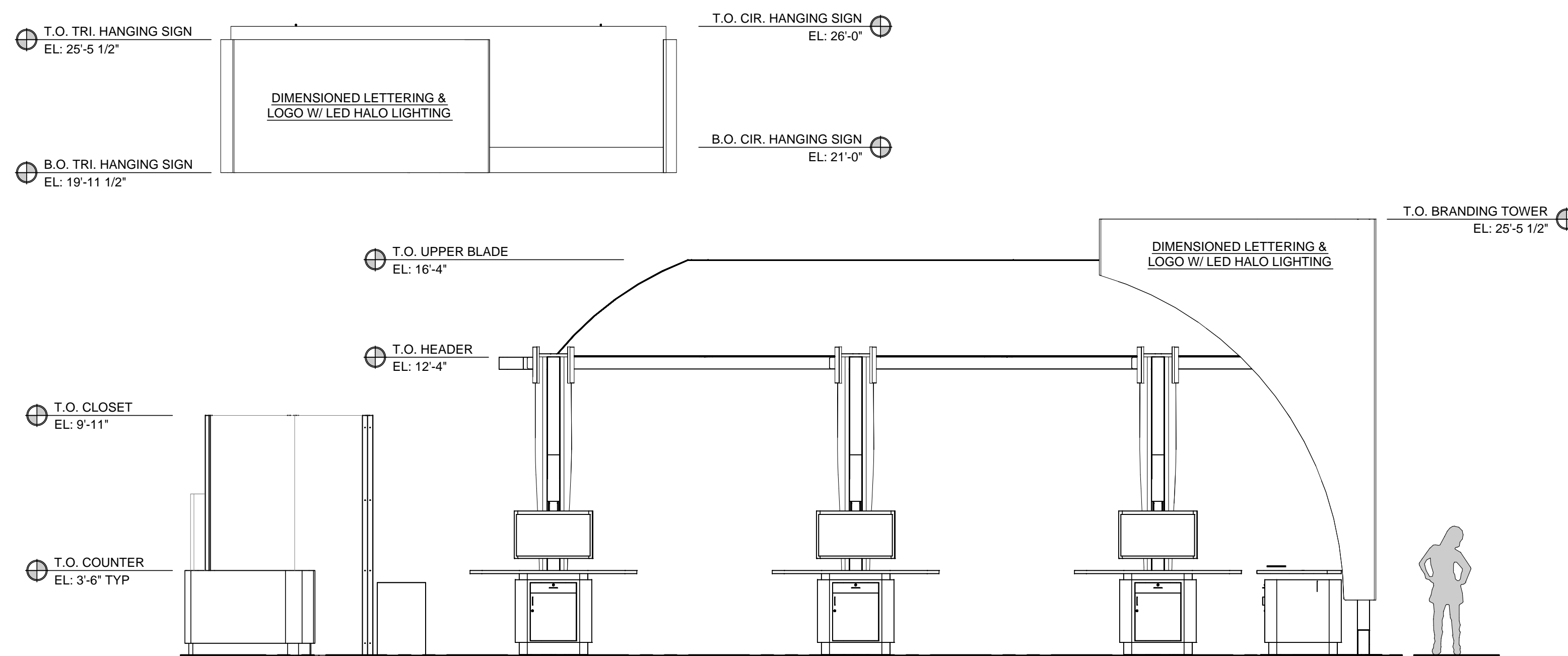

BACK SIDE ELEVATION VIEW

SCALE: 1/4" = 1'-0"

3
3.0

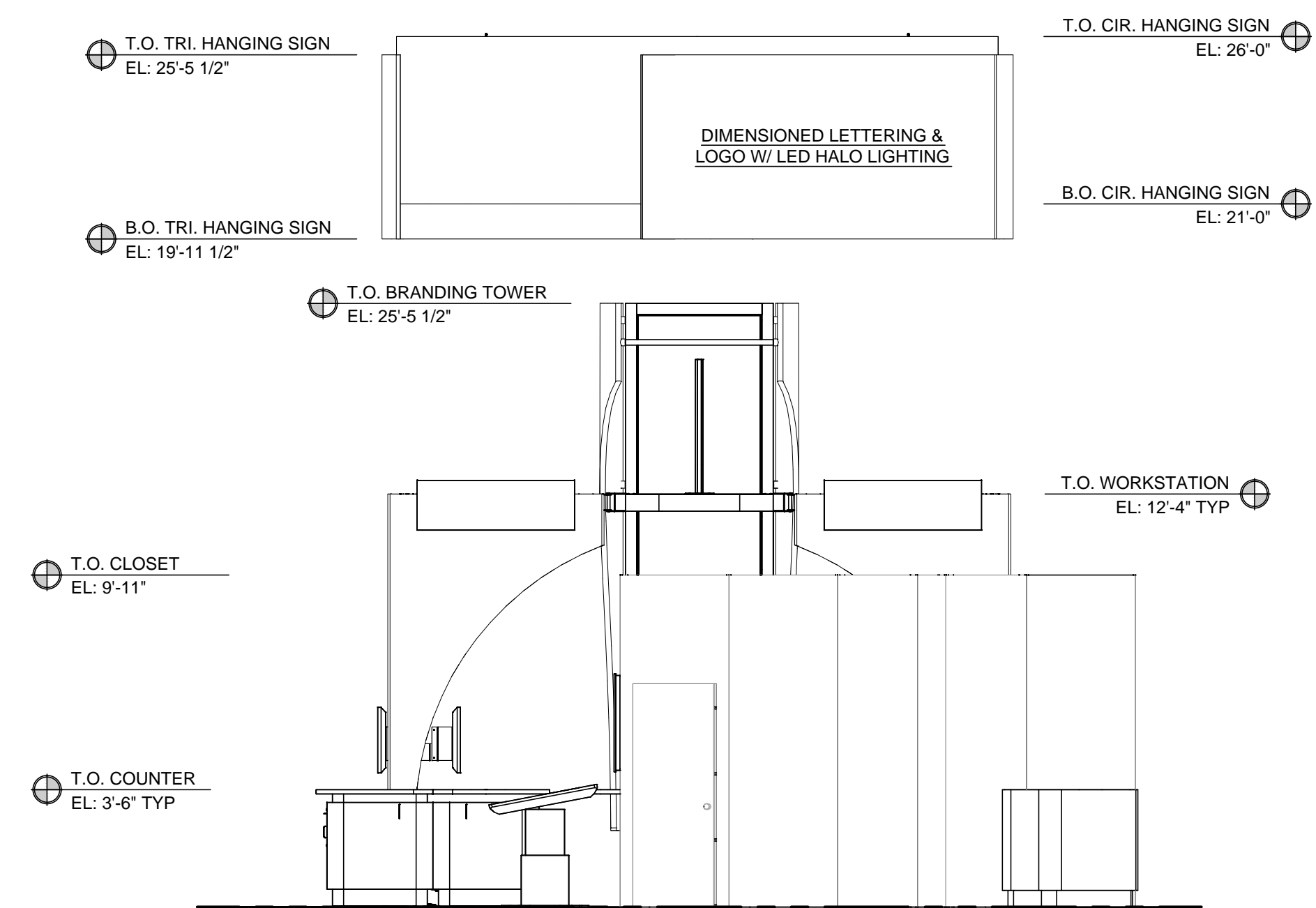

RIGHT SIDE ELEVATION VIEW

SCALE: 1/4" = 1'-0"

4
3.0

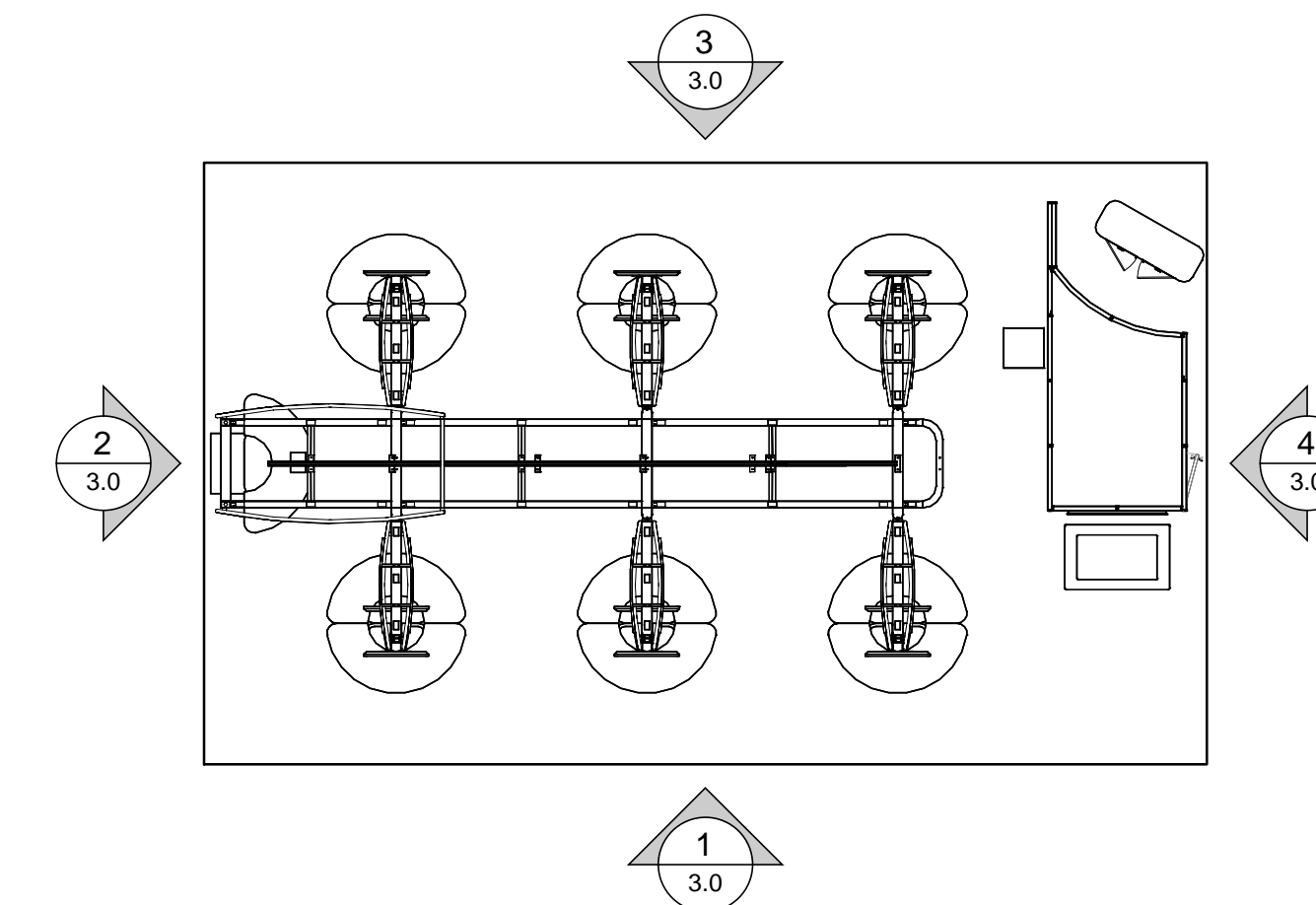

KEY PLAN

SCALE: N/A

Czarnowski
We love what we do.

Exhibit Services | Strategic Services | Event Services
11175 East 55th Avenue, Suite 100 Phone: 303.371.3344
Denver, CO 80239 Fax: 303.371.3437

Copyright © 2013 Czarnowski
The contents of this document are the property of Czarnowski and may not be reproduced, distributed, transmitted, displayed, or published without the prior written permission of Czarnowski.

ACCT. EXEC.	DESIGNER	DETAILER
		TH / PDL
CREATION DATE	ISSUE DATE	RELEASE DATE
11.12.13		
CLIENT NAME		
HOSPIRA		
SHOW NAME		
ASHIP 2013 - MID-YEAR CLINICAL MEETING		
VENUE		
ORANGE COUNTY CONVENTION CENTER		
ORLANDO, FL		
SETUP DATE	SHOW START	SHOW END
	12.7.13	12.11.13
BOOTH NUMBER	BOOTH AREA	HEIGHT RESTRICTION
923	30x50	
SHEET NAME		
ELEVATIONS		
PROJECT NUMBER (CLIENT CITY YEAR)		
HOSP 2013 13		

www.czarnowski.com \\DENVER\FS\Office\CAD\2013\Hospira\ASHIP\Hospira - ASHIP_2013_30 x 50 - Setups_v1.dwg - 11/14/2013

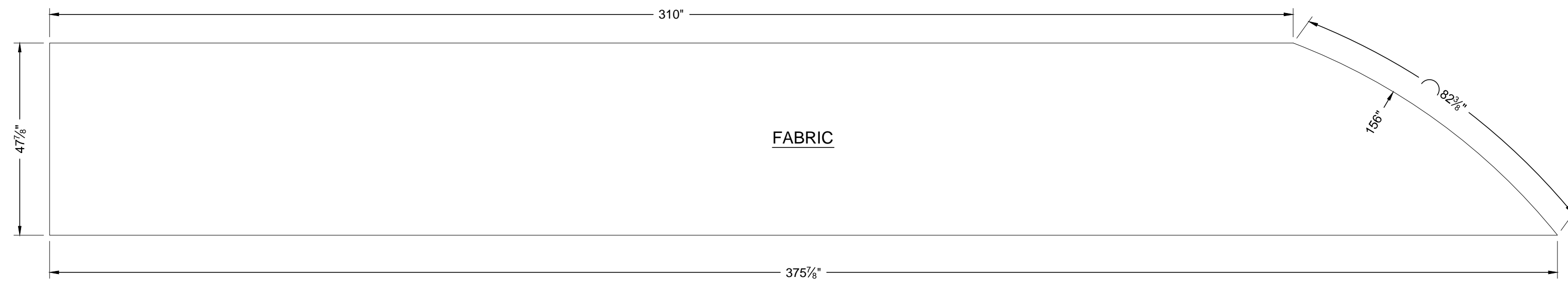

BLADE GRAPHIC FABRIC

SCALE: 1/2" = 1'-0"

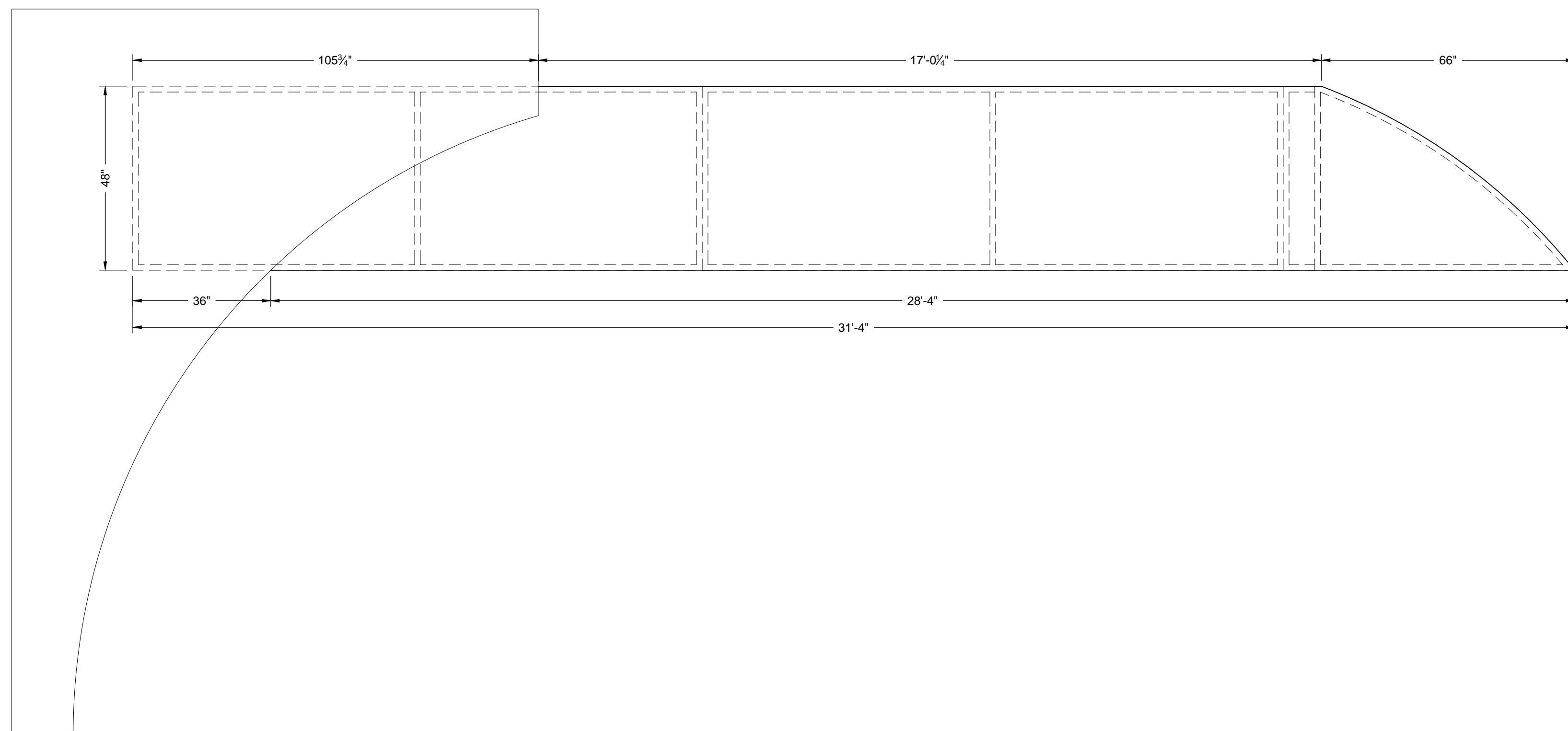

BLADE GRAPHIC ELEVATION

SCALE: 1/2" = 1'-0"

www.czarnowski.com \DEN\F5\Office\CAD\2013\Hospira\ASHIP\Hospira - ASHP_2013_30x50 - Setups_v1.dwg - 11/14/2013

Czarnowski
We love what we do.

Exhibit Services | Strategic Services | Event Services
11175 East 55th Avenue, Suite 100 Phone: 303.371.3344
Denver, CO 80239 Fax: 303.371.3437

Copyright © 2013 Czarnowski
The contents of this document are the property of Czarnowski and may not be reproduced, distributed, transmitted, displayed, or published without the prior written permission of Czarnowski.

ACCT. EXEC.	DESIGNER	DETAILER		
		TH / PDL		
CREATION DATE	ISSUE DATE	RELEASE DATE		
11.12.13				
CLIENT NAME				
HOSPIRA				
SHOW NAME				
ASHIP 2013 - MID-YEAR CLINICAL MEETING				
VENUE				
ORANGE COUNTY CONVENTION CENTER ORLANDO, FL				
SETUP DATE	SHOW START	SHOW END		
	12.7.13	12.11.13		
BOOTH NUMBER	BOOTH AREA	HEIGHT RESTRICTION		
923	30x50			
SHEET NAME				
BLADE GRAPHIC ELEVATION				
PROJECT NUMBER	CLIENT	CITY	YEAR	SHEET
				3.1

HOSPITALITY

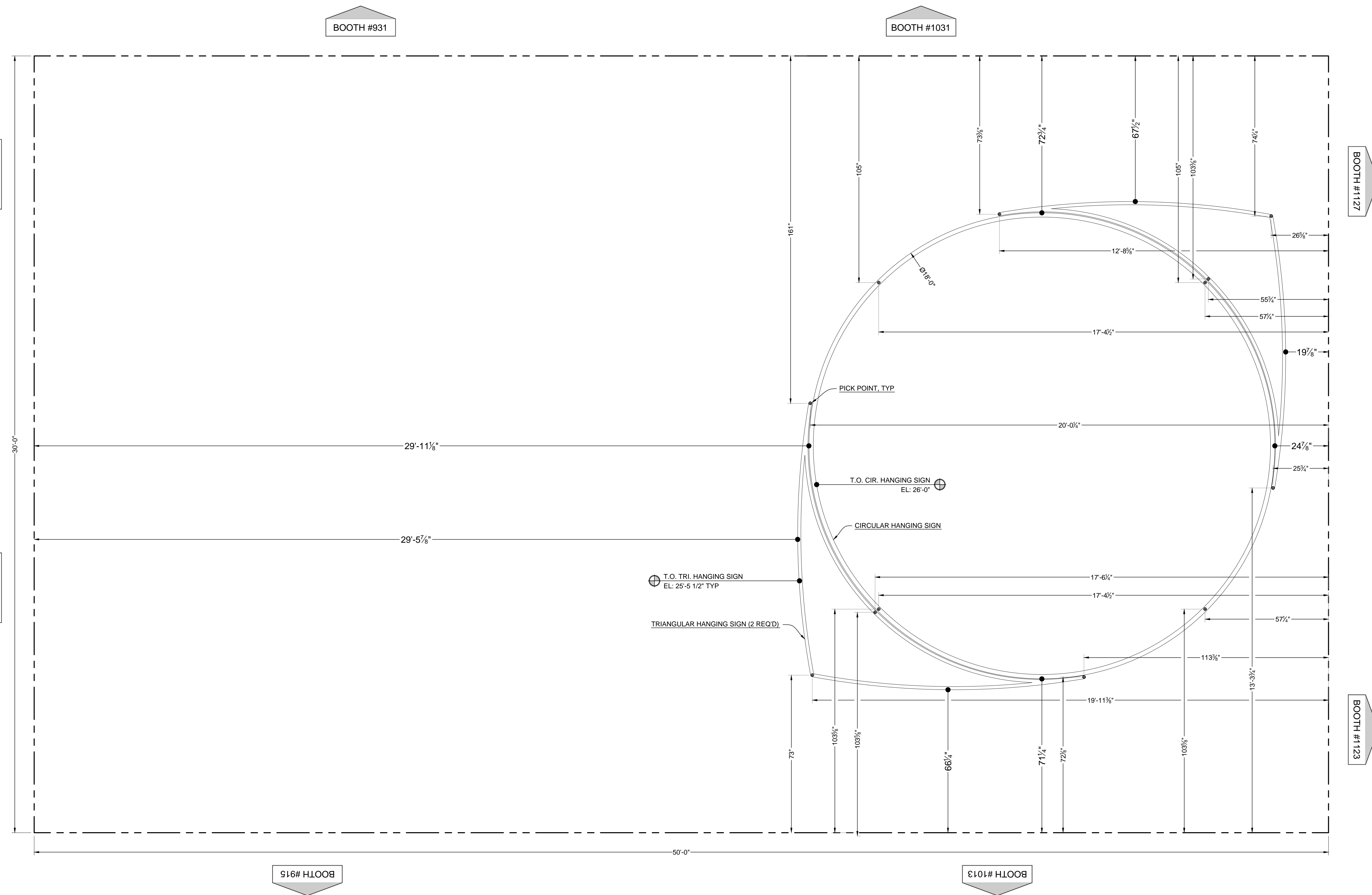

OVERHEAD PLAN VIEW - HANGING SIGNS
SCALE: 1/2" = 1'-0"

Czarnowski
We love what we do.

Exhibit Services | Strategic Services | Event Services
11175 East 55th Avenue, Suite 100 Phone: 303.371.3344
Denver, CO 80239 Fax: 303.371.3437

Copyright © 2013 Czarnowski
The contents of this document are the property of Czarnowski and may not be reproduced, distributed, transmitted, displayed, or published without the prior written permission of Czarnowski.

ACCT. EXEC.	DESIGNER	DETAILER
		TH / PDL
CREATION DATE	ISSUE DATE	RELEASE DATE
11.12.13		
CLIENT NAME		
HOSPIRA		
SHOW NAME		
ASHIP 2013 - MID-YEAR CLINICAL MEETING		
VENUE		
ORANGE COUNTY CONVENTION CENTER ORLANDO, FL		
SETUP DATE	SHOW START	SHOW END
	12.7.13	12.11.13
BOOTH NUMBER	BOOTH AREA	HEIGHT RESTRICTION
923	30x50	
SHEET NAME		
HANGING SIGNS		
PROJECT NUMBER	CLIENT	CITY
PROJECT NUMBER		SHEET
HOSP 2013		4.0

www.czarnowski.com \DEN\F5\Office\CAD\2013\Hospira\ASHIP\Hospira - ASHIP_2013_30x50 - Setups_v1.dwg - 11/14/2013

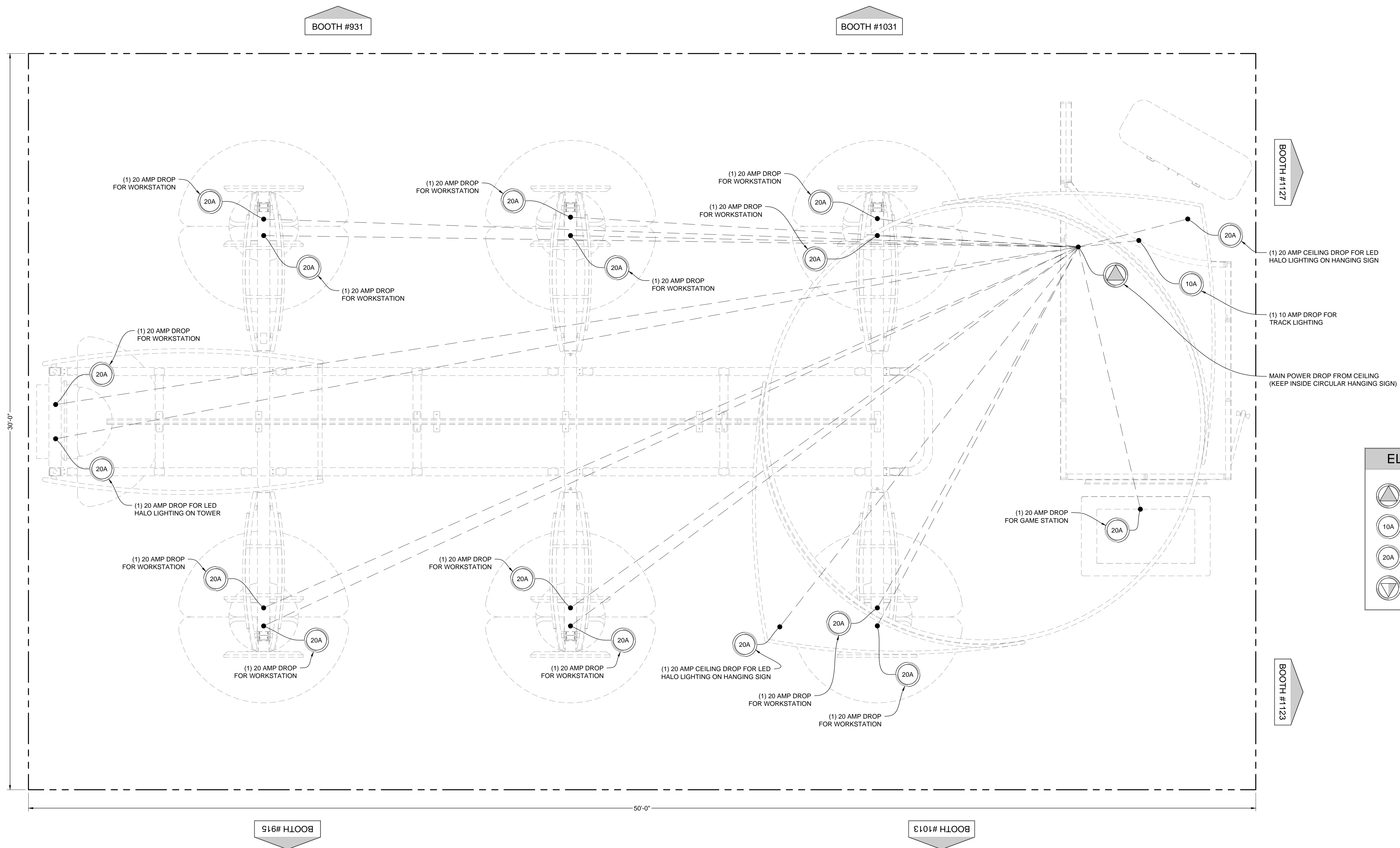

ELECTRICAL	
	MAIN POWER DROP
	10 AMP (1 REQ'D)
	20 AMP (17 REQ'D)
	INTERNET

OVERHEAD PLAN VIEW - ELECTRICAL LAYOUT
 SCALE: 1/2" = 1'-0"

Czarnowski
 We love what we do.

Exhibit Services | Strategic Services | Event Services
 11175 East 55th Avenue, Suite 100 Phone: 303.371.3344
 Denver, CO 80239 Fax: 303.371.3437

Copyright © 2013 Czarnowski
 The contents of this document are the property of Czarnowski and may not be reproduced, distributed, transmitted, displayed, or published without the prior written permission of Czarnowski.

ACCT. EXEC.	DESIGNER	DETAILER
		TH / PDL
CREATION DATE	ISSUE DATE	RELEASE DATE
11.12.13		
CLIENT NAME		
HOSPIRA		
SHOW NAME		
ASHIP 2013 - MID-YEAR CLINICAL MEETING		
VENUE		
ORANGE COUNTY CONVENTION CENTER		
ORALNDO, FL		
SETUP DATE	SHOW START	SHOW END
	12.7.13	12.11.13
BOOTH NUMBER	BOOTH AREA	HEIGHT RESTRICTION
923	30x50	
SHEET NAME		
ELECTRICAL LAYOUT		
PROJECT NUMBER CLIENT CITY YEAR		
HOSP_ASHIP_135.0		SHEET

www.czarnowski.com \DENVER\FloorCAD\2013\Hospira\ASHIP\Hospira - ASHIP_2013_30x50 - Setups_v1.dwg - 11/14/2013

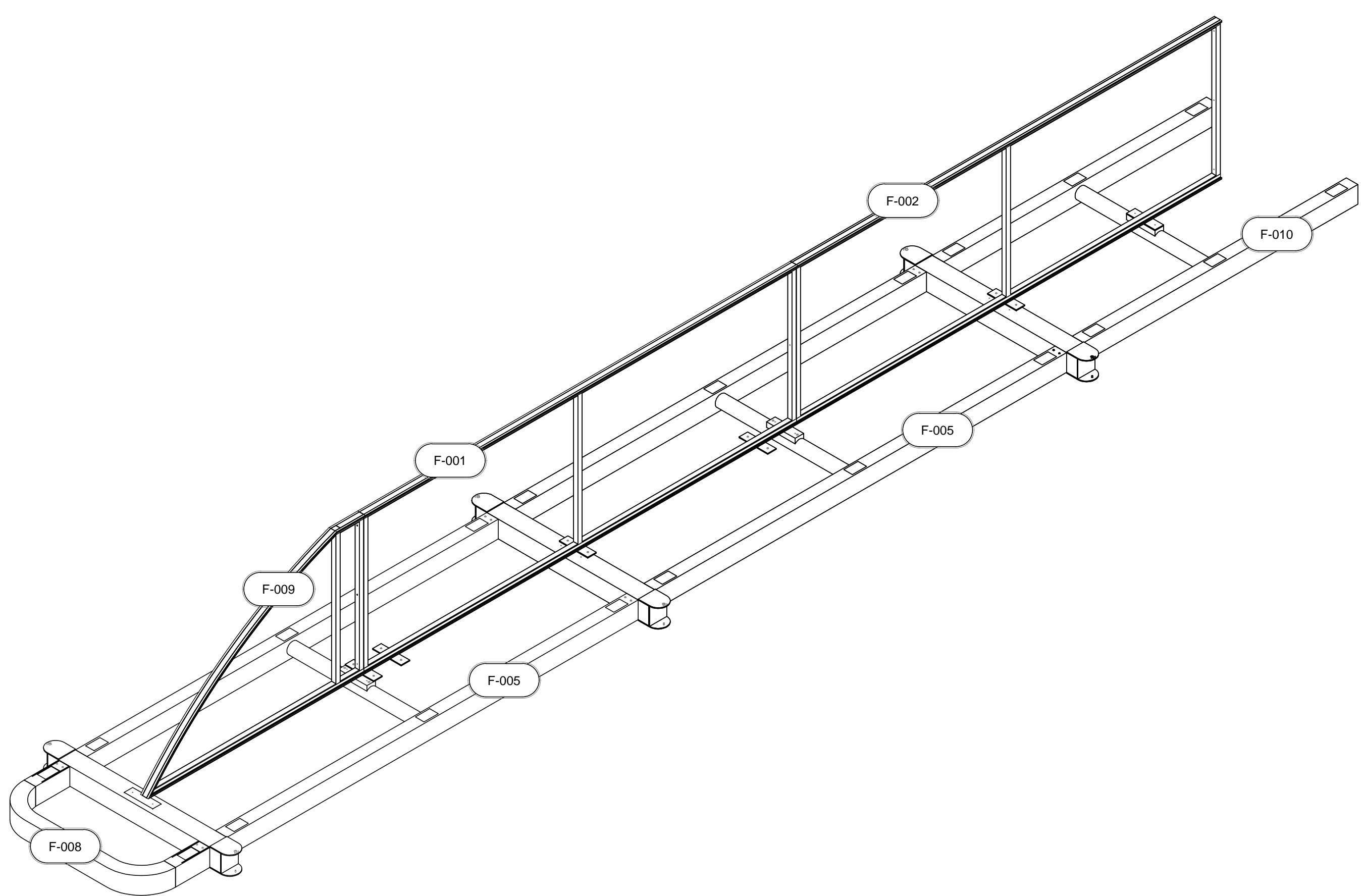

HEADER ASSEMBLY

SCALE: NTS

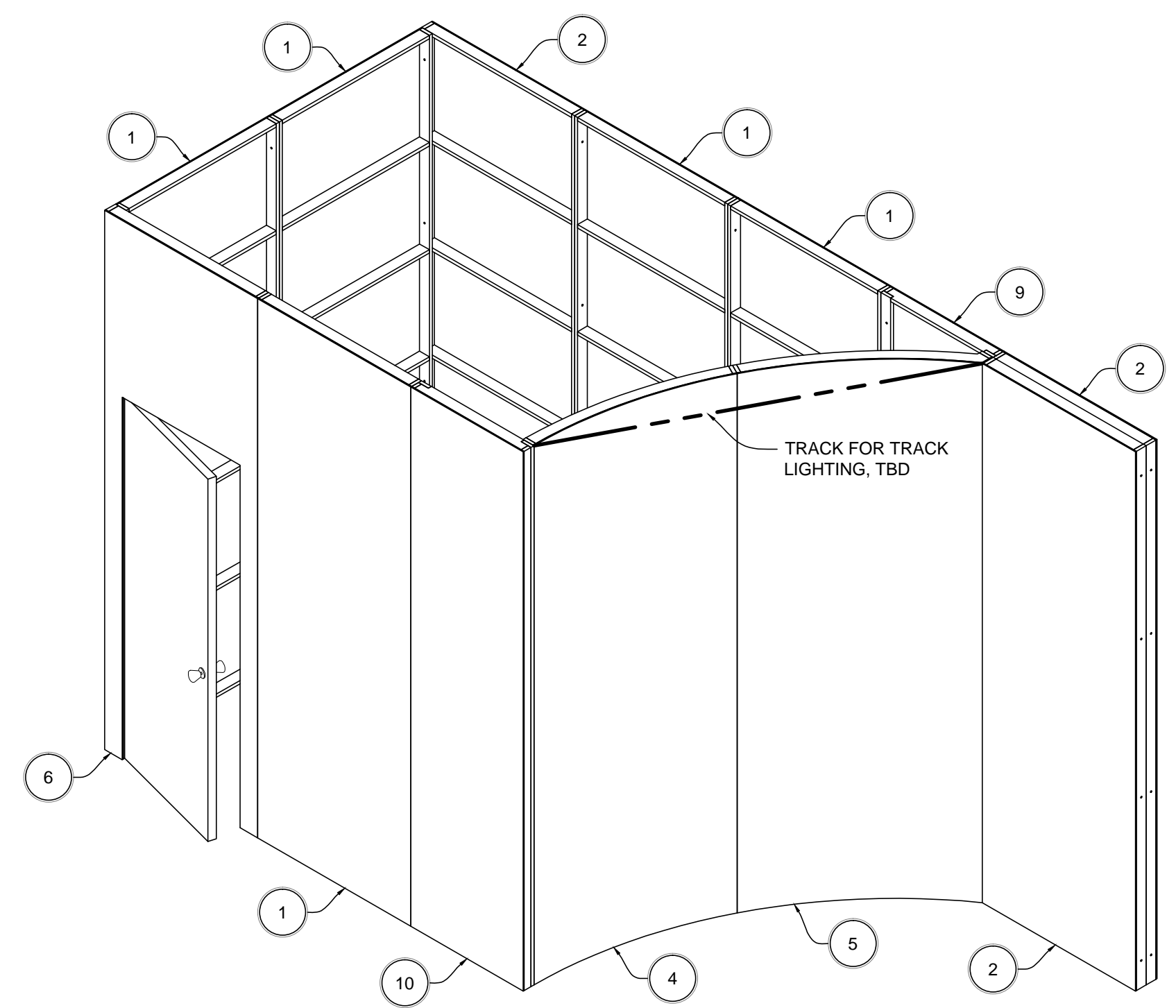

CLOSET ASSEMBLY

SCALE: NTS

www.czarnowski.com | \DEN\F5\Office\CAD\2013\Hospira\ASHIP\Hospira - ASHIP_2013_30x50 - Setups_v1.dwg - 11/14/2013

Czarnowski
We love what we do.

Exhibit Services | Strategic Services | Event Services
11175 East 55th Avenue, Suite 100 Phone: 303.371.3344
Denver, CO 80239 Fax: 303.371.3437

Copyright © 2013 Czarnowski. The contents of this document are the property of Czarnowski and may not be reproduced, distributed, transmitted, displayed, or published without the prior written permission of Czarnowski.

ACCT. EXEC.	DESIGNER	DETAILER
		TH / PDL
CREATION DATE	ISSUE DATE	RELEASE DATE
11.12.13		
CLIENT NAME		
HOSPIRA		
SHOW NAME		
ASHIP 2013 - MID-YEAR CLINICAL MEETING		
VENUE		
ORANGE COUNTY CONVENTION CENTER ORLANDO, FL		
SETUP DATE	SHOW START	SHOW END
	12.7.13	12.11.13
BOOTH NUMBER	BOOTH AREA	HEIGHT RESTRICTION
923	30x50	
SHEET NAME		
ASSEMBLY DRAWING		
PROJECT NUMBER	CLIENT	CITY YEAR

HOSPIRA ASHIP 136.0

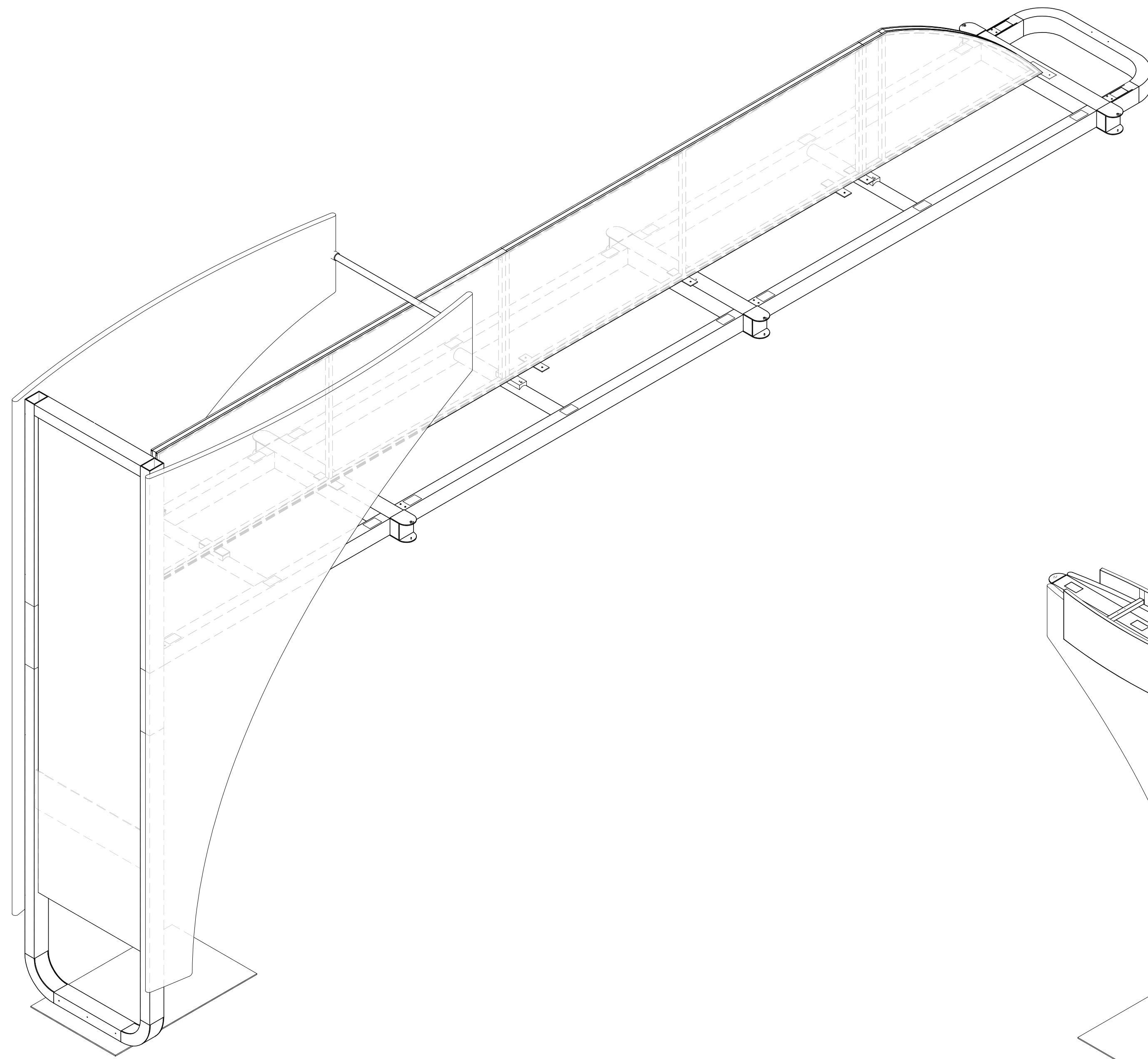

ISOMETRIC VIEW - TOWER, HEADER & BLADE

SCALE: NTS

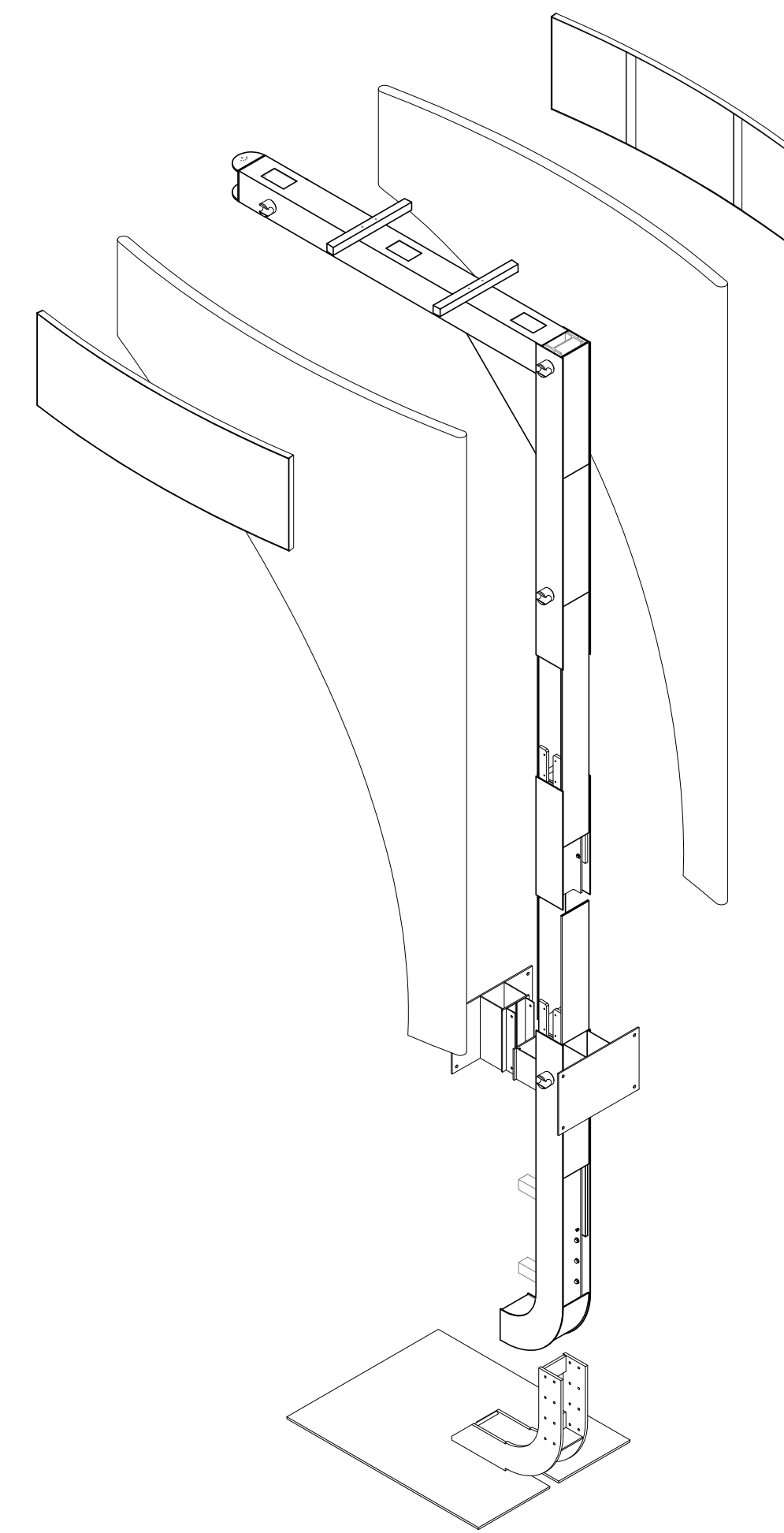

ISOMETRIC VIEWS - WORKSTATION

SCALE: NTS

www.czarnowski.com \DEN\F5\Office\CAD\2013\Hospira\ASHIP\Hospira - ASHP_2013_30x50 - Setups_v1.dwg - 11/14/2013

Czarnowski
We love what we do.

Exhibit Services | Strategic Services | Event Services
11175 East 55th Avenue, Suite 100 Phone: 303.371.3344
Denver, CO 80239 Fax: 303.371.3437

Copyright © 2013 Czarnowski
The contents of this document are the property of Czarnowski and may not be reproduced,
distributed, transmitted, displayed, or published without the prior written permission of Czarnowski.

ACCT. EXEC.	DESIGNER	DETAILER
		TH / PDL
CREATION DATE	ISSUE DATE	RELEASE DATE
11.12.13		
CLIENT NAME		
HOSPIRA		
SHOW NAME		
ASHIP 2013 - MID-YEAR CLINICAL MEETING		
VENUE		
ORANGE COUNTY CONVENTION CENTER ORALNDO, FL		
SETUP DATE	SHOW START	SHOW END
	12.7.13	12.11.13
BOOTH NUMBER	BOOTH AREA	HEIGHT RESTRICTION
923	30x50	
SHEET NAME		
ASSEMBLY DRAWING		
PROJECT NUMBER	CLIENT	CITY YEAR
HOSPIRA		136.1