

No. 48ST

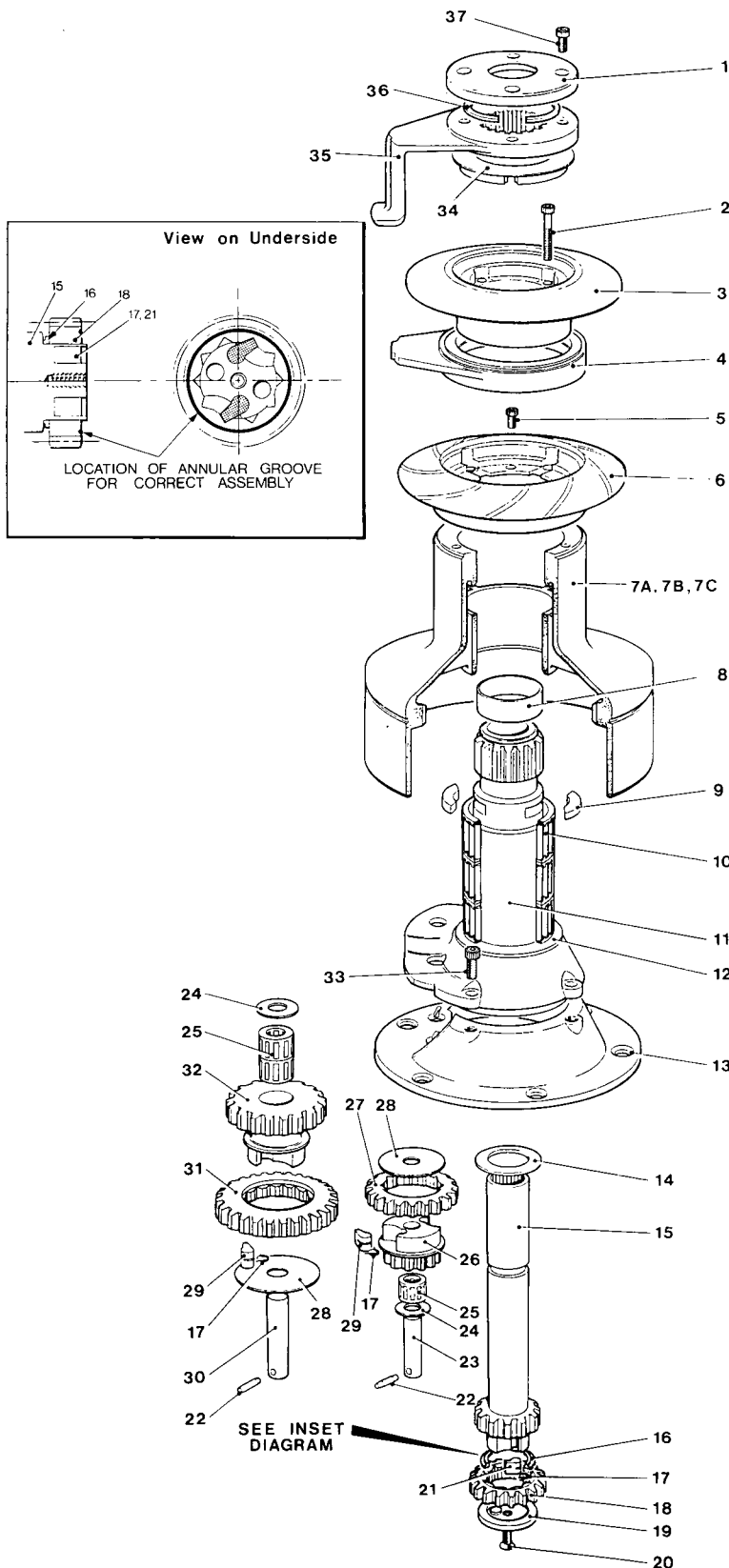

No. 48 Self Tailing Winch

Item No.	Part No.	Description	No. Off
1	15044639	Top Cap	1
2	B.0729	Skt. Hd. Cap Screw - 1/4" UNC x 1 1/2" Long	3
3	15048644	Upper Crown Plate	1
4	15048649	Stripper Ring	1
	15048641	Stripper Ring Insert	2
5	B.0723	Skt. Hd. Cap Screw - 1/4" UNC x 1/2" Long	3
6	15048635	Lower Crown Plate	1
7A	15000097	Drum - Bronze	1
7B	15048502	Drum - Alloy	1
7C	15048602	Drum - St. Steel	1
8	15000308	Collar	1
9	15040605	Key	2
10	15044121	Roller Bearing	3
11	15000012	Centre Stem - Upper	1
12	15044116	Drum - Washer	1
13	15000014	Centre Stem - Lower	1
14	1300/21	Washer	1
15	15048633	Spindle	1
16	15025107	Spacer	1
17	1260/7	Pawl Spring	6
18	15048104	Ratchet Gear	1
19	15016107	Spindle End Cap	1
20	B.0515	C'sk. Screw - 1/4" UNC x 1/2" Long	1
21	1260/8	Pawl	2
22	B.1516	Spirol Pin	2
23	15000016	Gear Spindle	1
24	1300/22	Washer	2
25	1300/SA2	Roller Bearing	3
26	1300/8	Pawl Gear	1
27	1300/7	Ratchet Gear	1
28	1264/7	Washer	2
29	1264/8	Pawl	4
30	15000015	Gear Spindle	1
31	1300/5	Ratchet Gear	1
32	1300/6	Pawl Gear	1
33	B.0719	Skt. Hd. Cap Screw - 5/16" UNC x 3/4" Long	4
34	15044627	Flanged Bush	1
35	15048648	Stripper Arm	1
36	15044637	Split Collet	2
37	B.0733	Skt. Hd. Cap Screw - 1/4" UNC x 3/8" Long	4